

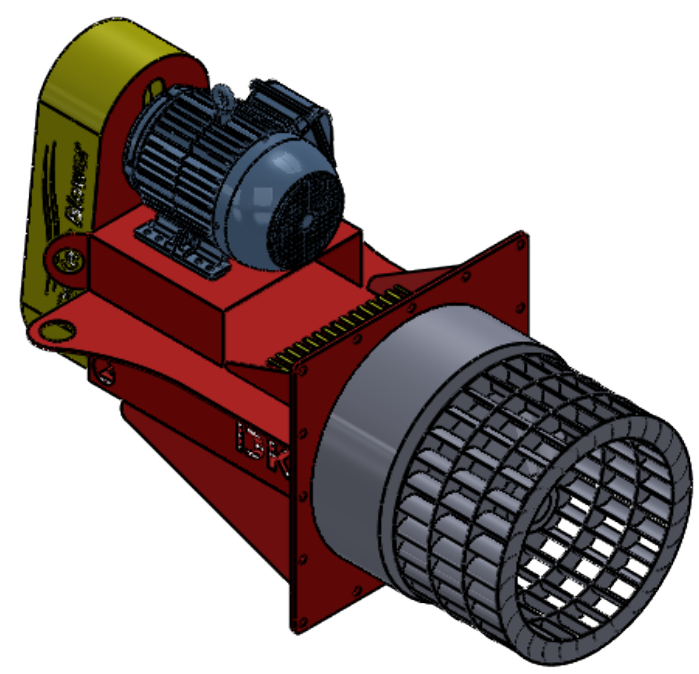

ALL DIMENSIONS MAY BE ALTERED TO SUIT CUSTOMER APPLICATION OR SPECIFICATIONS

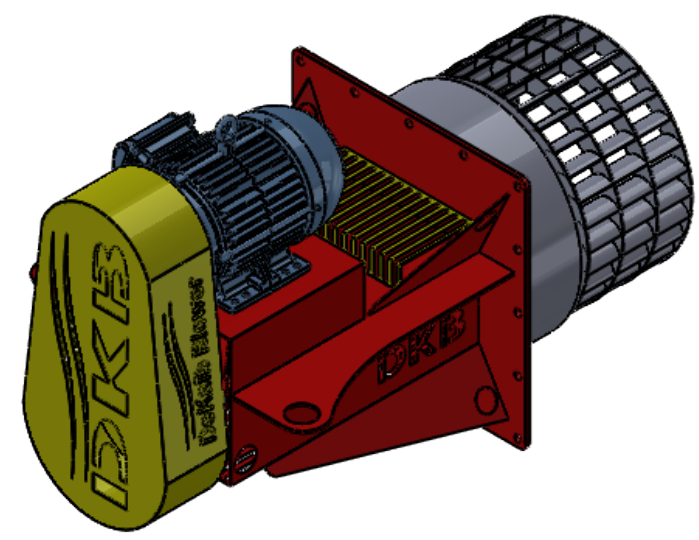
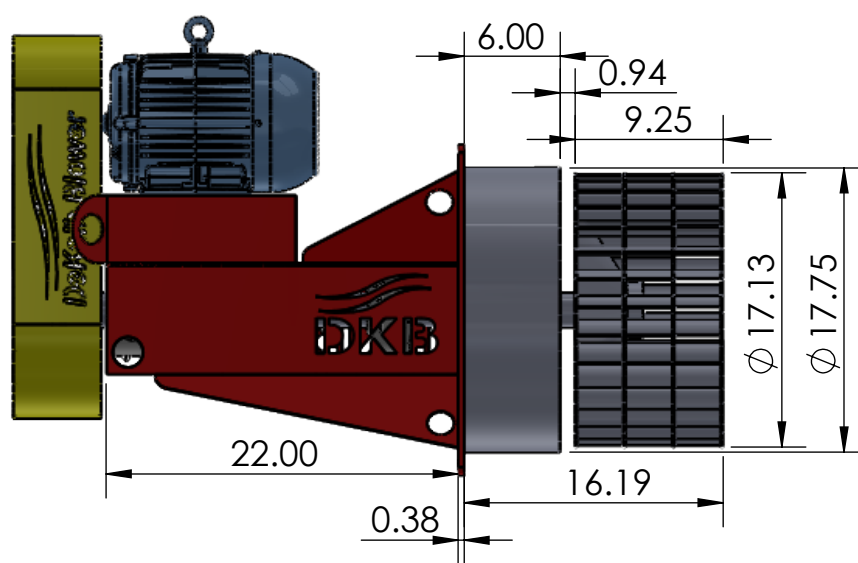
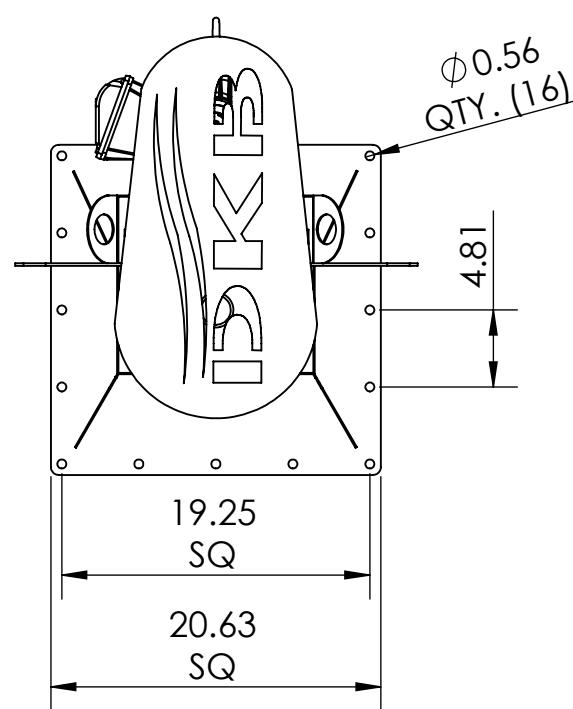

\* 7/16" CLEARANCE FROM FAN WHEEL TO INLET CONE

NEW PROJECT OR EXISING APPLICATION	[ ] NEW PROJECT [ ] EXISTING APPLICATION
MAXIMUM OPERATION TEMPERATURE	[ ] DEG.F
IF VFD USE PROVIDE MINIMUM AIRSTREAM TEMPERATURE FOR FULL DESIGNED CAPACITIES (CFM) FOR MOTOR SIZING	[ ] DEG.F
ROTATION	[ ] CW [ ] CCW [ ] PROXIMITY SWITCH RQD.
FAN PERFORMANCE REQUIRED @ STANDARD AIR CONDITIONS (.075#/CF@70DEG.F@29.92"HG BAR)	CFM: [ ] @ SP (INWC):[ ]
ATMOSPHERE TYPE	[ ] NONE [ ] ATMOSPHERE TYPE: [ ]
AIR OR WATER COOLED	[ ] AIR COOLED [ ] WATER COOLED
INSULATED PLUG DEPTH REQUESTED	[ ] INCHES [ ] SQUARE [ ] ROUND
MOUNTING FLANGE	[ ] SQUARE [ ] ROUND
ADDITIONAL INFORMATION	

NOTICE: UNAUTHORIZED USE, MANUFACTURE, OR REPRODUCTION IN WHOLE OR IN PART IS PROHIBITED, DRAWING DESIGN AND OTHER DISCLOSURES ARE SOLE PROPERTY OF DEKALB BLOWER INC. - P.O. BOX 516 - YORKVILLE - IL - 60560

REVISION		UNLESS OTHERWISE SPECIFIED: DIMENSIONS ARE IN INCHES SURFACE FINISH: TOLERANCES: LINEAR: ANGULAR:		+/- 1/8"  DO NOT SCALE DRAWING			
NAME	SIGNATURE	DATE	DEBURR AND BREAK SHARP EDGES		TITLE:		
DRAWN	BRIAN	3/23/2024	FINISH: DKB RED GUARDING YELLOW AIRSTREAM NONE		FHD 165 PLUG FAN		
CHK'D			MATERIAL: M/S S/S		DWG NO. FHD 165 PLUG FAN		
APPV'D			WEIGHT:		SCALE:1:12		
MFG					SHEET 1 OF 1		
Q.A					A3		